

# LOUVERED INDUSTRIAL FIXTURE

CATALOG NO.	LAMPS	BALLAST	POWER FACTOR	LENGTH	WIDTH	DEPTH	PCS/CTN	UNIT WT.
LI 5248 RS	2-34W	Rapid	High	48	12-1/2	9	1	24
LI 5272 SL	2-55W	Slimline	High	72	12-1/2	9	1	37
LI 5296 SL	2-60W	Slimline	High	96	12-1/2	9	1	42

- ⓓ Housing, reflectors, and louvers are die-formed steel, finished with baked white polyester powder coating.
- ⓓ Solid top, one and two piece reflector standard.
- ⓓ Rapid Start (RS), Slimline (SL), High Output (HO) or Very High Output (VHO) available.
- ⓓ Surface, pendant or chain mounting, aircraft cable, unit or row installation.
- ⓓ Louvers removable without the use of tools.
- ⓓ Reflector removes without the use of tools.
- ⓓ Special "hidden" aircraft cable hanging system available upon request.
- ⓓ Additional lengths available on request.



H Lighting Company, Inc. • St. Louis, Missouri • 314/773-1176 • FAX 314/773-1176

All H & H Lighting Fixtures are completely wired for 118 volts 60 cycle A.C. operation. Ready for installation. All fixtures bear the I.B.E.W., A. F. of L. and Underwriters Laboratories labels.

# LOUVERED INDUSTRIAL

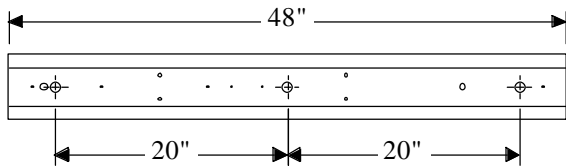
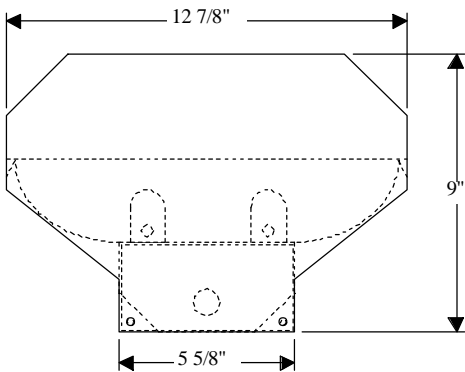
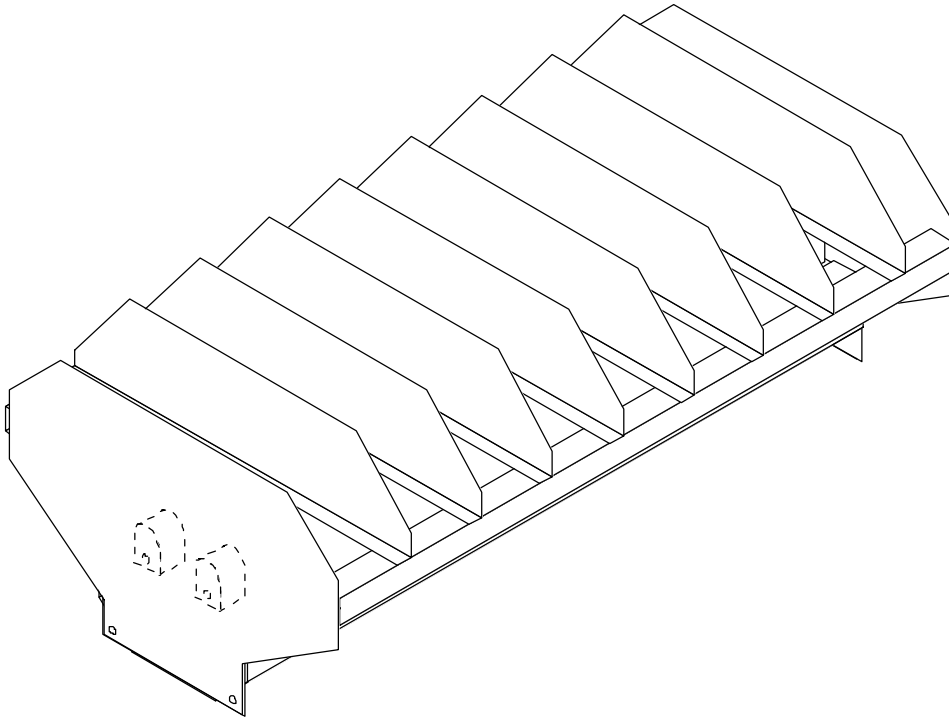

**MOUNTING** - Complete with knockouts for surface mounting or pendant mounting, individually or in continuous rows. Pendant mounting accessories available on specification. Conduit knockouts are supplied on ends and back.

**ELECTRICAL** - Furnished standard with UL listed ballasts, for 120 Volt 60 Hz A.C. operation. Other voltages and accessories available. Fixtures bear the I.B.E.W., A.F. of L., and Underwriters' Laboratories, Inc. labels.

**APPLICATION** - All industrial fixtures are designed for quick, easy installation either, hanging or flush, individually or continuous rows.

**CONSTRUCTION** - Wireway and ends die-formed of code gauge steel, finished in automatic bonderizing, rust preventative process, with high reflectivity powder coated baked white enamel. Reflector is removable for easy access to electrical components.